

ÜBERSICHTSZEICHNUNG
ASSEMBLY DRAWING

GHOST



HYB HTX 2.7 / 4.7 (MY20)

Datum: 24-08-2020

Version: 02



HYB HTX 2.7 / 4.7 (MY20)
date: 24-08-2020
version: 02

ÜBERSICHTSZEICHNUNG ASSEMBLY DRAWING

GHOST

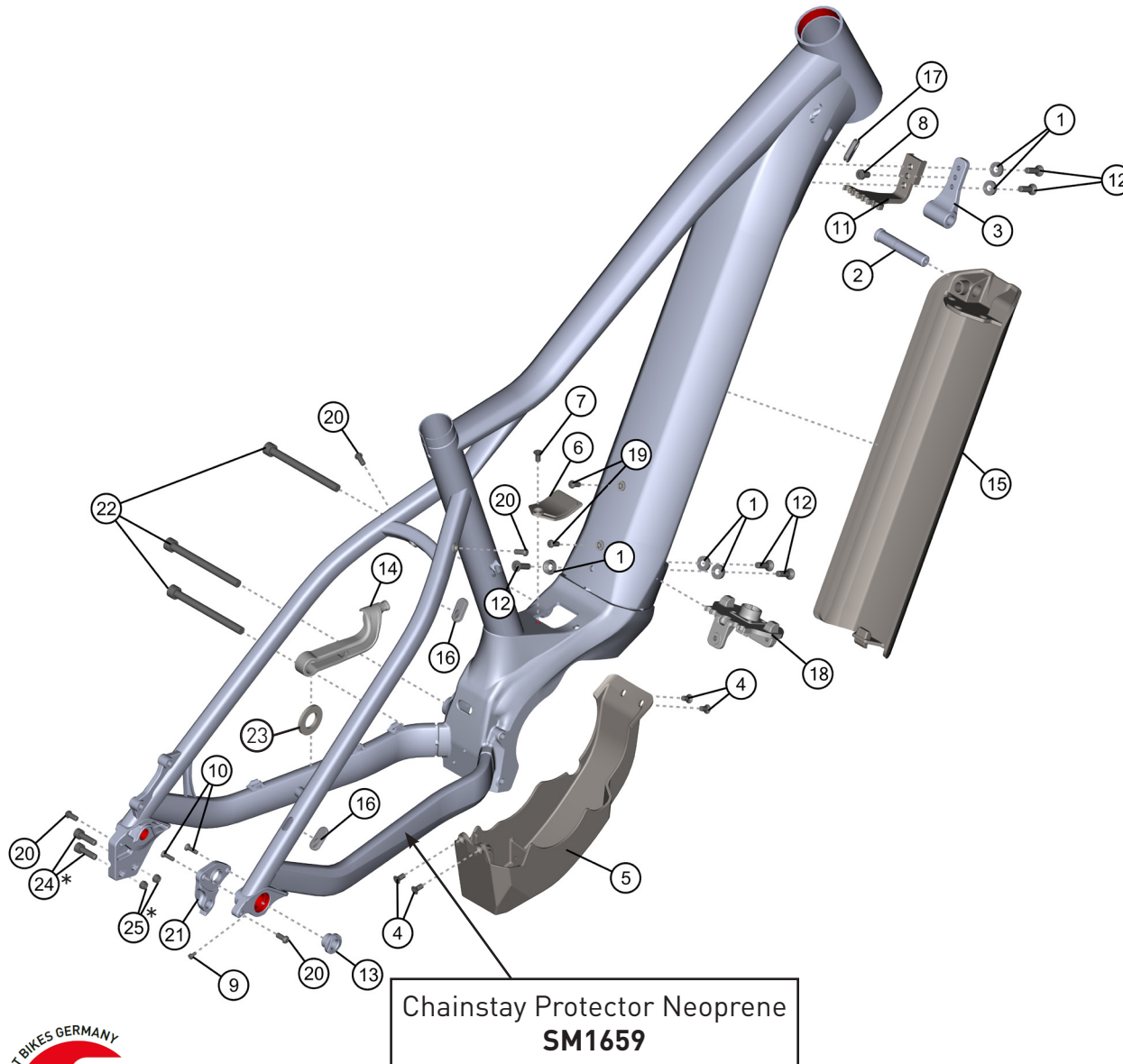

Hinweis: Bei den Schrauben muss mittelfeste Gewindesicherung verwendet werden.
Rote Flächen müssen gefettet werden.

Note: use medium strength screw lock for screw threads.
red surfaces has to be greased.

FACT SHEET:	
SHOCK LENGTH:	-----
SHOCK HARDWARE:	
TOP:	-----
BOTTOM:	-----
HEADSET:	
TOP:	ZS 44
BOTTOM:	ZS 56
SEATPOST DIAMETER:	31.6 MM
CLAMP INNER DIAMETER:	34.9 MM
BOTTOM BRACKET:	-----
KICKSTAND:	KSA 18
ISCG STANDARD:	-----

HYB HTX 2.7 / 4.7 (MY20)
date: 24-08-2020
version: 02



ÜBERSICHTSZEICHNUNG

ASSEMBLY DRAWING

GHOST

BOM-ID	Description	Specification	Torque	Item no.	QTY
1	Spacer	Ø 15 x 4 mm		FROT0143	5
2	Battery lock axle	T40 - Ø 14 (M12) x 66 mm	10 Nm	FROT0144	1
3	Battery cover mount			FROT0145	1
4	Counter sunk screw	Hex 3 - M5 x 10 mm	6 Nm	FRSC0086	4
5	PW-ST Motor Cover			FROT0085	1
6	PW-ST BB Top Cover			FROT0086	1
7	Counter sunk screw	Hex 3 - M5 x 10 mm	6 Nm	FRSC0086	1
8	Hexagon socket screw	Hex 5 - M6 x 10 mm	11 Nm	FRSC0080	1
9	Hexagon socket screw	Hex 2,5 - M3 x 5 mm	1 Nm	FRSC0081	1
10	Counter sunk screw	Hex 2,5 - M4 x 12 mm	3 Nm	FRSC0082	2
11	DT cable guide			FROT0146	1
12	Counter sunk screw	Hex 4 - M6 x 20 mm	11 Nm	FRSC0083	5
13	Hanger Nut	Ø 21 (M12) x 11,9 mm		FROT0152	1
14	Sensor holder			FROT0088	1
15	Battery cover			FROT0153	1
16	Cable guide SW-415			FROT0154	2
17	Cable guide YF-W13-1			FROT0155	1
18	Battery Connector			FROT0157	1
19	Lens head screw	T25 - M5 x 10 mm	6 Nm	FRSC0087	2
20	Lens head screw	T25 - M5 x 10 mm	6 Nm	FRSC0088	4
21	Hanger			FROT0156	1
22	Hexagon socket screw	Hex 6 - M8 x 65 mm	28 Nm	FRSC0066	3
23	Spacer for sensor			SM1743	1
24*	Hexagon socket screw (for kickstand)	Hex 4 - M5 x 20 mm	6 Nm	SM1229	2
25*	Self locking nut (for kickstand)	M5		SM1238	2



HYB HTX 2.7 / 4.7 (MY20)

date: 24-08-2020

version: 02